

NOTES:

1. HORIZ. REINF. SHALL BE EMBEDDED 4" MIN. INTO ADJACENT CONCRETE COLUMNS (IF APPLICABLE).
2. LAPPING OF HORIZ. REINF. SHALL BE 16" MIN. (ONE BLOCK LENGTH).

TYP. FILLED CELL DETAIL
SCALE: 3/4"=1'-0"

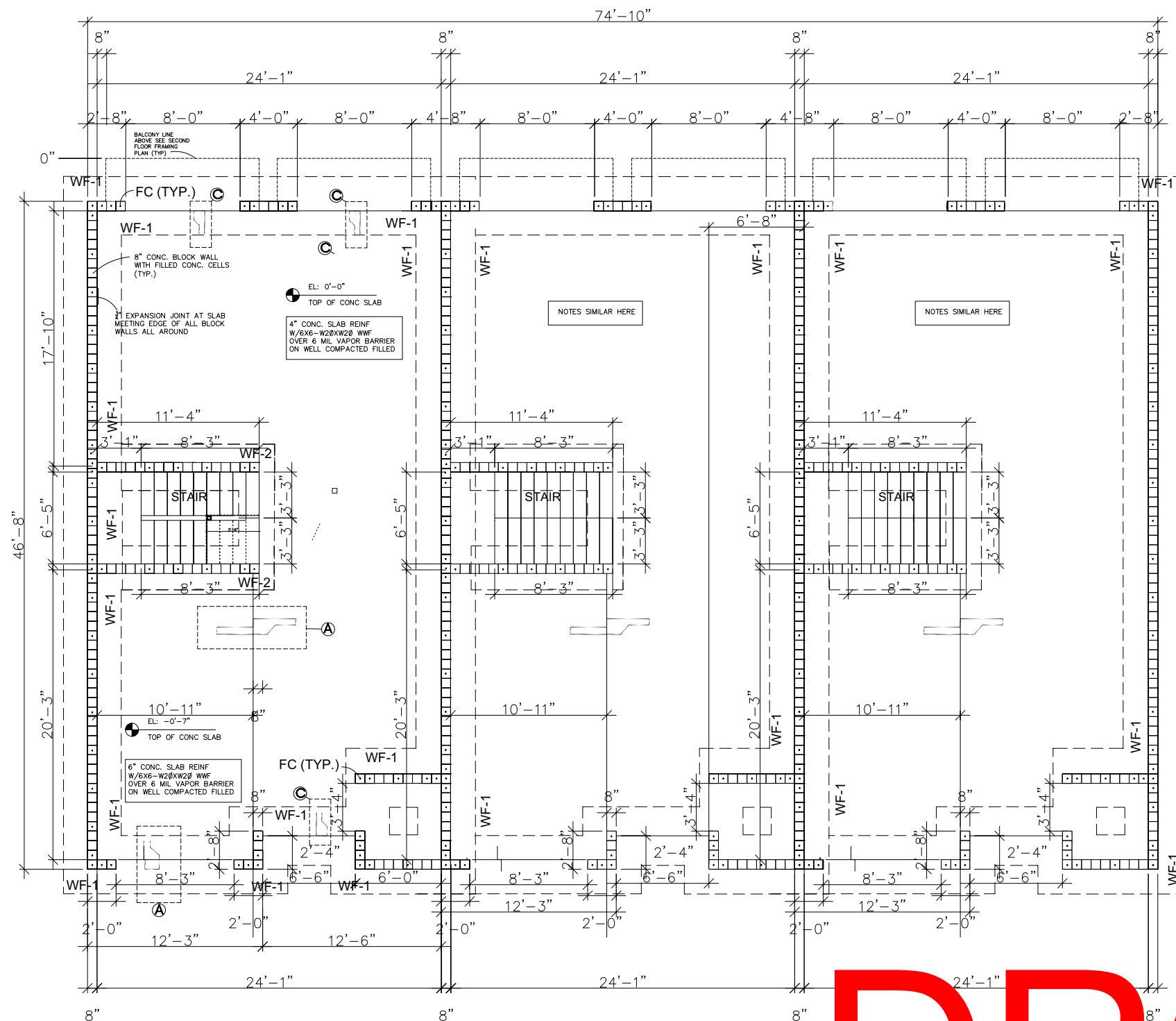

FOUNDATION / GROUND FLOOR PLAN

SCALE: $\frac{1}{4}" = 1'-0"$

FOOTING SCHEDULE				
MARK	SIZE	REINF.		
WF-1	48"x 20"	5#5	CONT. # 4 @ 4"	W.
WF-2	36"x16"	4#5	CONT. # 4 @ 4"	W.
FC	# 5 IN FILLED CONC. CELLS @ 32"			(SEE VARIATION)

REVISIONS

TOWNHOUSES AT NW 19 AVE

MIAMI
ARCHITECT
INC.

7755 SW 117 ST. MIAMI, FL 33156
TEL: (305) 256-1720
AA 28000671

Taghi Afkham
Digitally signed by Taghi Afkham
Date: 2023.07.27 20:13:01 +04'00'

Printed copy is not considered valid and sealed
DIGITAL SIGNATURE NUMBER
6832CF3B...M4

TAGHI AFKHA
 STATE OF FLORIDA
 AR0014758
 DATE: 03/

PZ23-12000026
11/15/2023

S-1